

Unofficial Property Record Card - Hopedale, MA

General Property Data

Parcel ID **12-26-0**
Prior Parcel ID **984 --**
Property Owner **NOT AVAILABLE**

Account Number **0**

Mailing Address

Property Location **9 HOME PARK AV**
Property Use **ONE FAM**
Most Recent Sale Date **8/1/2013**
Legal Reference **51346-387**
Grantor **WORTHINGTON,JOHN T**

City

Mailing State Zip

Sale Price **259,900**

ParcelZoning **RB**

Land Area **0.184 acres**

Current Property Assessment

Card 1 Value Building Value **112,500**

Xtra Features Value **0**

Land Value **80,300**

Total Value **192,800**

Building Description

Building Style **RANCH**
of Living Units **1**
Year Built **1951**
Building Grade **AVERAGE**
Building Condition **Average**
Finished Area (SF) **1498**
Number Rooms **5**
of 3/4 Baths **0**

Foundation Type **CONCRETE**
Frame Type **WOOD**
Roof Structure **GABLE**
Roof Cover **ASPHALT SH**
Siding **WOOD SHING**
Interior Walls **DRYWALL**
of Bedrooms **2**
of 1/2 Baths **1**

Flooring Type **HARDWOOD**
Basement Floor **N/A**
Heating Type **FORCED H/W**
Heating Fuel **OIL**
Air Conditioning **0%**
of Bsmt Garages **0**
of Full Baths **1**
of Other Fixtures **1**

Legal Description

Narrative Description of Property

This property contains 0.184 acres of land mainly classified as ONE FAM with a(n) RANCH style building, built about 1951, having WOOD SHING exterior and ASPHALT SH roof cover, with 1 unit(s), 5 room(s), 2 bedroom(s), 1 bath(s), 1 half bath(s).

Property Images

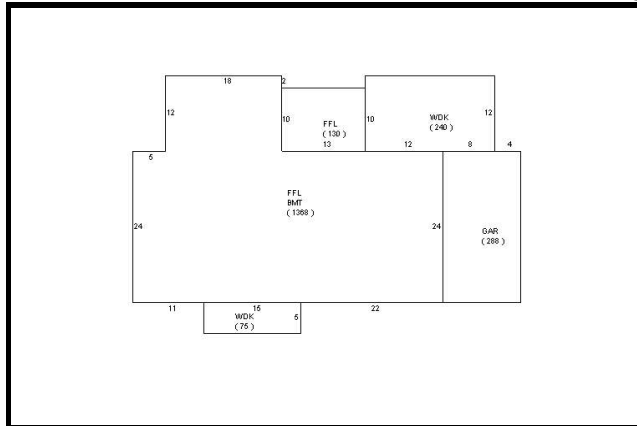

Disclaimer: This information is believed to be correct but is subject to change and is not warranted.